

.....Dialight



DuroSite® LED Linear Fixture - UL / CSA
for Indoor and Outdoor Industrial Applications



On when it matters most.

Products and solutions that protect your business

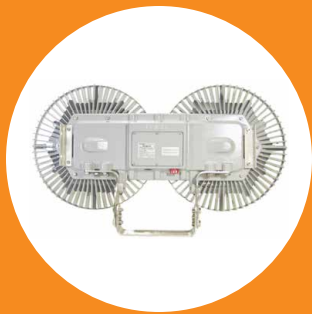



Features & Benefits

- 5-year warranty
- L70 rated for >100,000 hours @ 25°C
- Instant on/off operation
- Resistant to water, salt, dust & vibration
- Resistant up to 20 PSI of hose directed water
- Universal input (100-277 VAC, 50/60Hz)
- Integrated wiring box
- Low profile housing for limited space applications
- Temperature compensation technology for longer life

Application

Dialight's DuroSite® LED linear fixture replaces HID and fluorescent lighting fixtures in industrial applications. The DuroSite® LED Linear fixture's rugged solid state design makes it highly resistant to shock and vibration. Its fully gasketed IP66 rated enclosure makes it suitable for dusty & wet locations, its 1598/A rating guarantees added protection from salt water spray. The DuroSite® LED Linear's superior design allows for wiring and mounting versatility and ease of installation for many lighting applications.

DuroSite LED Linear - UL / CSA

Low Profile

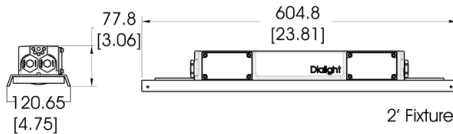
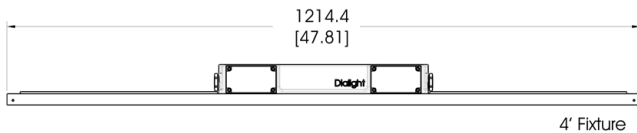

Dimensions in inches [mm]

Certifications & Ratings

- UL 1598/A*
- CSA C22.2 No. 250*
- IP66/67
- NEMA 4X

*ETL listed

Mechanical Information:

Fixture weight:	4' - 10 lb (4.5 kg) 2' - 7 lb (3.2 kg)
Shipping weight:	4' - 11 lb (5.0 kg) 2' - 8 lb (3.6 kg)
Mounting:	(4) 3/4" NPT openings Optional swivel bracket - LPXW4 Optional low profile bracket - LPXW4LP

Electrical Specifications:

Operating voltage:	100-277 VAC, 50/60Hz
Power consumption:	See ordering information
Operating temp:	-40°F to +149°F (-40°C to +65°C)
Harmonics:	IEC 61000-3-2
Noise requirements/EMC:	FCC Title 47, Subpart B, Section 15, Class A device. RF Immunity; 10V/m, 80MHz-1GHz
Surge protection:	EN 61000-4-5 4 kV line-to-line 4 kV line-to-ground
THD:	< 20%
Power factor:	> 0.9

Power supply equipped with inline fuse

Construction:

Finish:	Superior dual coat finish - Sealed polyester topcoat - Chemical resistant epoxy primer
Lens:	Polycarbonate

Photometric Information:

CRI:	75, 80
CCT:	5000K (cool white) 4000K (neutral white)
IES files:	Available at www.dialight.com

All values typical unless otherwise stated (tolerance +/- 10%)

*For information on chemical compatibility, please follow this link to reference Dialight's Chemical Compatibility Guide: www.dialight.com/pubs/MDTFCHEMRFLX001.PDF

DuroSite LED Linear - UL / CSA

Top Conduit

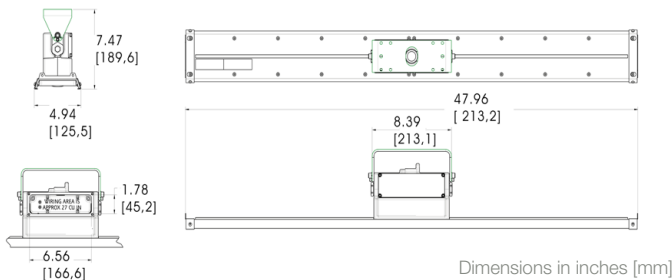

Certifications & Ratings

- UL 1598/A*
- CSA C22.2 No. 250*
- IP66
- NEMA 4X

*ETL listed

Mechanical Information:

- Fixture weight:** 4' - 10 lb (4.5 kg)
2' - 7 lb (3.2 kg)
- Shipping weight:** 4' - 11 lb (5.0 kg)
2' - 8 lb (3.6 kg)
- Mounting:** (3) 3/4" NPT openings
Optional swivel bracket - LTXW4
Optional low profile bracket - LTXW4LP

Electrical Specifications:

- Operating voltage:** 100-277 VAC, 50/60Hz
- Power consumption:** See ordering information
- Operating temp:** -40°F to +149°F (-40°C to +65°C)
- Harmonics:** IEC 61000-3-2
- Noise requirements/EMC:** FCC Title 47, Subpart B, Section 15, Class A device. RF Immunity; 10V/m, 80MHz-1GHz
- Surge protection:** EN 61000-4-5
4 kV line-to-line
4 kV line-to-ground
- THD:** < 20%
- Power factor:** > 0.9

Power supply equipped with inline fuse

Construction:

- Finish:** Superior dual coat finish
- Sealed polyester topcoat
- Chemical resistant epoxy primer
- Lens:** Polycarbonate

Photometric Information:

- CRI:** 75, 80
- CCT:** 5000K (cool white)
4000K (neutral white)
- IES files:** Available at www.dialight.com

All values typical unless otherwise stated (tolerance +/- 10%)

For information on chemical compatibility, please follow this link to reference Dialight's Chemical Compatibility Guide: www.dialight.com/pubs/MDTFCHEMRFLX001.PDF

DuroSite LED Linear - UL / CSA

Battery Backup

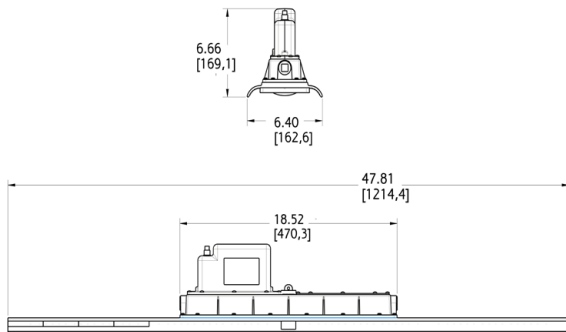

Dimensions in inches [mm]

Certifications & Ratings

- UL 1598/A*
- UL 924*
- CSA C22.2 No. 250*
- IP66
- NEMA 4X

*ETL listed

Mechanical Information:

- Fixture weight:** 18 lb (8.2 kg)
- Shipping weight:** 21 lb (9.5 kg)
- Mounting:** (1) Threaded 3/4" NPT side
(2) Threaded 3/4" NPT ends

Electrical Specifications:

- Operating voltage:** 120-277 VAC, 50/60Hz
- Power consumption:** 85W
- Operating temp:** -4°F to +149°F (-20°C to +65°C)
- Battery:** 3.6V 10Ah Nimh
- Battery life*:** 3 years
- Battery duration*:** > 3 hours
- Lumen output in Battery Mode:** 450lm
- Harmonics:** IEC 61000-3-2
- Noise requirements/EMC:** FCC Title 47, Subpart B, Section 15, Class A device. RF Immunity; 10V/m, 80MHz-1GHz
- Surge protection:** EN 61000-4-5
1 kV line to line
2 kV line to ground
- THD:** < 20%
- Power factor:** > 0.9

Construction:

- Finish:** Superior dual coat finish
- Sealed polyester topcoat
- Chemical resistant epoxy primer
- Lens :** Polycarbonate

Photometric Information:

- CRI:** 75
- CCT:** 5000K (cool white)
4000K (neutral white)
- IES files:** Available upon request

All values typical unless otherwise stated (tolerance +/- 10%)

*For information on chemical compatibility, please follow this link to reference Dialight's Chemical Compatibility Guide: www.dialight.com/pubs/MDTFCHEMRFLX001.PDF

*@ 25°C ambient

DuroSite LED Linear - UL / CSA

Mounting and Accessories

Low Profile Linear



LPXW4LP

- 316 Stainless steel low profile mounting bracket
- Can be angled at 0° and 15°



LPXW4

- 316 Stainless steel mounting bracket
- Can be angled at 0°, 30°, 45°, 60° & 90°



LTXENDCAPKIT

- 304 Stainless steel chain mount and secondary retention bracket



LTXSAFEKIT

- Safety Cable Kit for secondary retention

Top Conduit Linear



LTXW4

- Aluminum mounting bracket
- Can be angled at 0°, 30°, 45°, 60° and 90°



LTXW4LP

- Aluminum low profile mounting bracket
- Can be angled at 0° and 15°

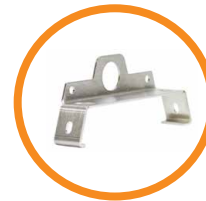

LTXENDCAPKIT

- 304 Stainless steel chain mount and secondary retention bracket



LTXSAFEKIT

- Safety cable kit for secondary retention



LTXLSXW4

- Retrofit bracket adapter used to connect LTM model fixtures to an existing LSXW4 bracket

Battery Backup Linear



LSXW4

- Aluminum mounting bracket
- Can be angled at 0°, 30°, 45°, 60° and 90°



LSXENDCAPKIT

- 304 Stainless steel chain mount brackets



HZXSAFEKIT

- Safety cable kit

DuroSite LED Linear - UL / CSA

Low Profile - Ordering Information and Light Distribution Pattern

Part Number	Length	CRI	Fixture Lumens	Watt	lm/W	Warranty	Voltage	CCT	Lens	Beam Distribution
LPM3C4M2P	4'	75	7,250	66	110	5yr	100-277 VAC	5000K (cool white)	Clear Polycarbonate	Medium
LPM3C4H2W	4'	75	6,700	66	102	5yr	100-277 VAC	5000K (cool white)	Diffused Polycarbonate	Medium
LPM3B4M2P	4'	80	6,500	66	98	5yr	100-277 VAC	5000K (cool white)	Clear Polycarbonate	Medium
LPM3B4H2W	4'	80	6,000	66	91	5yr	100-277 VAC	5000K (cool white)	Diffused Polycarbonate	Medium
LPM3C4D2P	2'	75	3,600	33	109	5yr	100-277 VAC	5000K (cool white)	Clear Polycarbonate	Medium
LPM3C4B2W	2'	75	3,300	33	100	5yr	100-277 VAC	5000K (cool white)	Diffused Polycarbonate	Medium
LPM3B4D2P	2'	80	3,200	33	97	5yr	100-277 VAC	5000K (cool white)	Clear Polycarbonate	Medium
LPM3B4B2W	2'	80	2,900	33	88	5yr	100-277 VAC	5000K (cool white)	Diffused Polycarbonate	Medium

All values typical unless otherwise stated, Lumen values are typical (tolerance +/- 10%).
 The part numbers in the above table are provided in 5000K (cool white). To order part numbers in 4000K (neutral white), please change the 5th character to an **N**. Ex. LPM3**C**4M2P becomes LPM3**N**4M2P.

Light Distribution Pattern

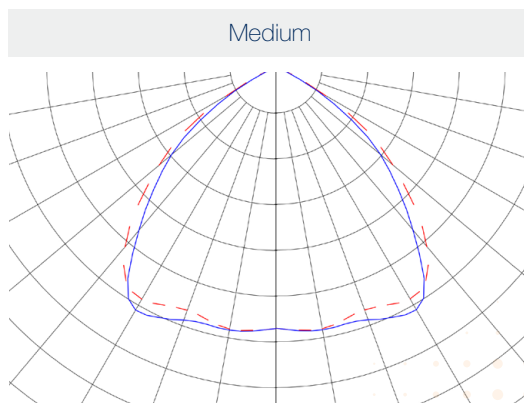

DuroSite LED Linear - UL / CSA

Top Conduit - Ordering Information and Light Distribution Pattern

Part Number	Length	CRI	Fixture Lumens	Watt	lm/W	Warranty	Voltage	CCT	Lens	Beam Distribution
LTM3C4M2P	4'	75	7,250	66	110	5yr	100-277 VAC	5000K (cool white)	Clear Polycarbonate	Medium
LTM3C4H2W	4'	75	6,700	66	102	5yr	100-277 VAC	5000K (cool white)	Diffused Polycarbonate	Medium
LTM3B4M2P	4'	80	6,500	66	98	5yr	100-277 VAC	5000K (cool white)	Clear Polycarbonate	Medium
LTM3B4H2W	4'	80	6,000	66	91	5yr	100-277 VAC	5000K (cool white)	Diffused Polycarbonate	Medium
LTM3C4D2P	2'	75	3,600	33	109	5yr	100-277 VAC	5000K (cool white)	Clear Polycarbonate	Medium
LTM3C4B2W	2'	75	3,300	33	100	5yr	100-277 VAC	5000K (cool white)	Diffused Polycarbonate	Medium
LTM3B4D2P	2'	80	3,200	33	97	5yr	100-277 VAC	5000K (cool white)	Clear Polycarbonate	Medium
LTM3B4B2W	2'	80	2,900	33	88	5yr	100-277 VAC	5000K (cool white)	Diffused Polycarbonate	Medium

All values typical unless otherwise stated, Lumen values are typical (tolerance +/- 10%).
 Part numbers listed in the table above are cool white. For neutral white model, replace the 5th character with N. Ex. LTM3C4D2P becomes LTM3N4D2P

Light Distribution Pattern

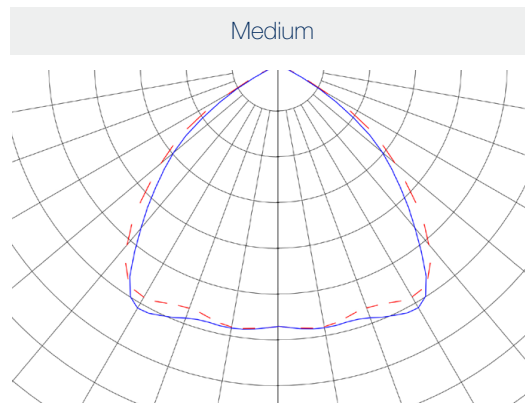

DuroSite LED Linear - UL / CSA

Battery Backup - Ordering Information and Accessories

Part Number	Length	Type	CRI	Fixture Lumens	Watt	lm/W	Warranty	Voltage	CCT	Lens	Beam Distribution
LSM3C4MEP	4'	Sustained	75	7,000	85	82	3yr	120- 277 VAC	5000K (cool white)	Clear Polycarbonate	Medium
LSM3C4MNP	4'	Maintained	75	7,000	85	82	3yr	120-277 VAC	5000K (cool white)	Clear Polycarbonate	Medium

All values typical unless otherwise stated, Lumen values are typical (tolerance +/- 10%).
 The part numbers in the above table are provided in Cool White. To order part numbers in Neutral White, please change the 5th character to an **N**. Ex. LSM3**C**4MEP becomes LSM3**N**4MEP

Light Distribution Pattern

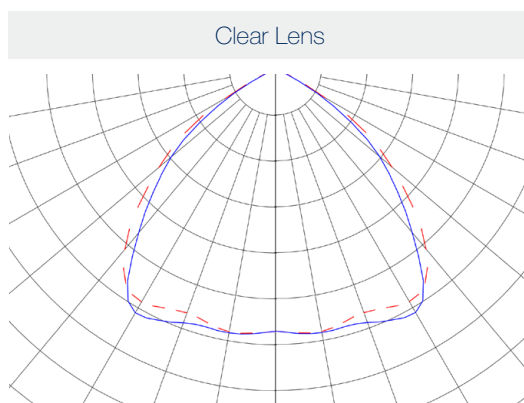

North American HQ

1501 Route 34 South
Farmingdale, NJ 07727
Tel: 732-919-3119
Fax: 732-751-5778
info@dialight.com

EMEA Technical Centre

Ejby Industrivej 91 B
200 Glostrup
Tel: +45 8877 4545 (Denmark)
Tel: +44 1638 666541 (UK)
Tel: +49 89 12089 5713 (Germany)
Tel: +33 3 23 22 62 58 (France)
sales-europe@dialight.com

Houston

16830 Barker Springs Rd
Ste 407
Houston, TX 77084
Tel: 732-919-3119
Fax: 281-492-1531
info@dialight.com

Middle East

Level 42
Emirates Towers (Office Tower)
Sheikh Zayed Road
Dubai, United Arab Emirates
Fax: +971 (0) 4319 7686
Tel: +971 (0) 4319 7686

Australia

38 O'Malley Street
Osborne Park, WA 6017
Tel: +61 (0) 8 9244 7600
Fax: +61 (0) 8 9244 7601
info@dialight.com.au

Southeast Asia

33 Ubi Avenue 3
#07-72 Vertex (Tower A)
Singapore 408868
Tel: +65 6578 7157
Fax: +65 6578 7150
enquiry@dialight.com.sg

Brazil

Alameda Mercurio,
225 – American Park Empresarial NR
Indaiatuba – SP – 13347– 662
Tel: +55 (19) 3113-4300
Fax: +55 (19) 3113-4300
brasil@dialight.com

ALL VALUES ARE DESIGN OR TYPICAL VALUES WHEN MEASURED UNDER LABORATORY CONDITIONS. THE LIGHTING EFFICIENCY STATEMENTS CONTAINED HEREIN ARE CALCULATED ON A LUMEN PER WATTS BASIS WHEN COMPARING FIXTURES WITH SIMILAR FEATURES. ALL INFORMATION PROVIDED IS ACCURATE AS OF THE DATE OF PUBLICATION, IS SUBJECT TO CHANGE WITHOUT NOTICE AND DOES NOT FORM PART OF ANY CONTRACT WITH DIALIGHT. DIALIGHT DOES NOT WARRANT OR REPRESENT THAT ITS PRODUCTS ARE FIT FOR ANY PARTICULAR PURPOSE AND HAS NO RESPONSIBILITY FOR THE [INAPPROPRIATE/UNAUTHORISED/NON-APPROVED] USE OF ANY DIALIGHT PRODUCTS BY THE END USER.

Dialight reserves the right to make changes at any time in order to supply the best product possible.

The most current version of this document will always be available at: www.dialight.com