

Dialight



DuroSite[®] LED Linear Fixture - UL / CSA
for Indoor and Outdoor Industrial Applications



On when it matters most.

Products and solutions that protect your business

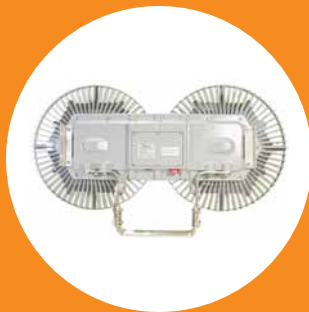



Features & Benefits

- 5-year full performance warranty
- L70 rated for >100,000 hours @ 25°C
- DLC listed (80 CRI CW & NW models only)
- Instant on/off operation
- Resistant to water, salt, dust & vibration
- Resistant up to 20 PSI of hose directed water
- Universal input (100 - 277V AC), 50/60Hz
- Integrated wiring box
- Low profile housing for limited space applications
- Temperature compensation technology for longer life

Application

Dialight's DuroSite® LED linear fixture replaces HID and fluorescent lighting fixtures in industrial applications. The DuroSite® LED Linear fixture's rugged solid state design makes it highly resistant to shock and vibration. Its fully gasketed IP66 rated enclosure makes it suitable for dusty & wet locations, its 1598/A rating guarantees added protection from salt water spray. The DuroSite® LED Linear's superior design allows for wiring and mounting versatility and ease of installation for many lighting applications.

DuroSite LED Linear - UL / CSA

Low Profile

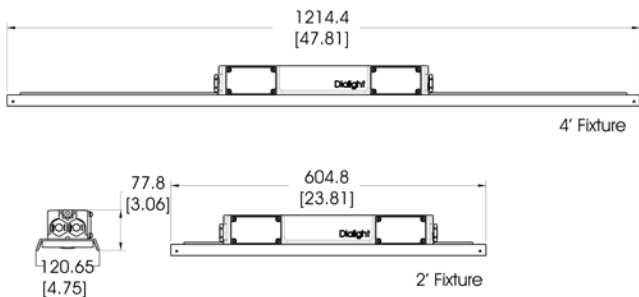

Dimensions in inches [mm]

Certifications & Ratings

- UL 1598/A
- UL 8750
- CSA 22.2 No. 250
- IP66 / 67
- NEMA 4X

Mechanical Information:

- Fixture weight:** 4' - 10 lbs (4.50 kg)
2' - 7 lbs (3.13 kg)
- Shipping weight:** 4' - 11 lbs (4.90 kg)
2' - 8 lbs (3.64 kg)
- Mounting:** (4) 3/4" NPT openings
Optional swivel bracket - LPXW4
Optional low profile bracket - LPXW4LP

Electrical Specifications:

- Operating voltage:** 100 - 277V AC, 50/60Hz
- Power consumption:** See ordering information
- Operating temp:** -40°F to +149°F (-40°C to +65°C)
- Harmonics:** IEC 61000-3-2
- Noise requirements/EMC:** FCC Title 47, Subpart B, Section 15, Class A device. RF Immunity; 10V/m, 80MHz-1GHz
- Surge protection:** EN 61000-4-5
4 kV line to line
4 kV line to ground
- THD:** < 20%
- Power factor:** > 0.9

Power supply equipped with inline fuse

Construction:

- Finish:** Superior dual coat finish
- Sealed polyester topcoat
- Chemical resistant epoxy primer
- Lens:** Polycarbonate

Photometric Information:

- CRI:** 75, 80
- CCT:** 5000 (cool white)
4000 (neutral white)
- IES files:** Available at www.dialight.com

All values typical unless otherwise stated
Lumen values are typical (tolerance +/- 10%)

DuroSite LED Linear - UL / CSA

Top Conduit

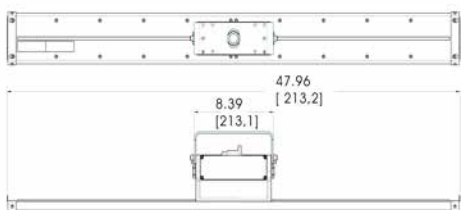

Dimensions in inches [mm]

Certifications & Ratings

- UL 1598/A
- UL 8750
- CSA 22.2 No. 250
- IP66
- NEMA 4X

Mechanical Information:

- Fixture weight:** 4' - 11 lbs (4.99 kg)
2' - 10 lbs (4.53 kg)
- Shipping weight:** 4' - 13 lbs (5.90 kg)
2' - 12 lbs (5.44 kg)
- Mounting:** (3) 3/4" NPT openings
Optional swivel bracket - LTXW4
Optional low profile bracket - LTXW4LP

Electrical Specifications:

- Operating voltage:** 100 - 277V AC, 50/60Hz
- Power consumption:** See ordering information
- Operating temp:** -40°F to +149°F (-40°C to +65°C)
- Harmonics:** IEC 61000-3-2
- Noise requirements/EMC:** FCC Title 47, Subpart B, Section 15, Class A device. RF Immunity; 10V/m, 80MHz-1GHz
- Surge protection:** EN 61000-4-5
4 kV line to line
4 kV line to ground
- THD:** < 20%
- Power factor:** > 0.9

Power supply equipped with inline fuse

Construction:

- Finish:** Superior dual coat finish
- Sealed polyester topcoat
- Chemical resistant epoxy primer
- Lens:** Polycarbonate

Photometric Information:

- CRI:** 75, 80
- CCT:** 5000 (cool white)
4000 (neutral white)
- IES files:** Available at www.dialight.com

All values typical unless otherwise stated
Lumen values are typical (tolerance +/- 10%)

DuroSite LED Linear - UL / CSA

Battery Backup

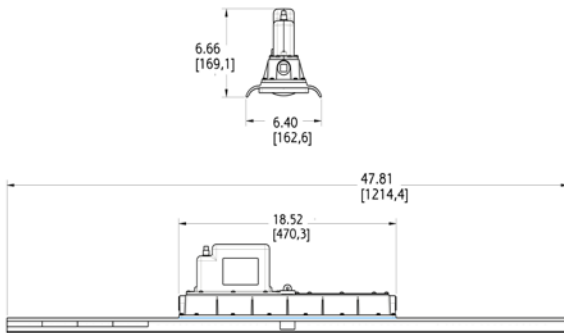

Dimensions in inches [mm]

Certifications & Ratings

- UL1598/A
- UL924
- CSA 22.2 No. 250
- IP66
- NEMA 4X

Mechanical Information:

Fixture weight:	18 lbs (8.16 kg)
Shipping weight:	21 lbs (9.53 kg)
Mounting:	(1) Threaded 3/4" NPT side (2) Threaded 3/4" NPT ends

Electrical Specifications:

Operating voltage:	120 - 277V AC, 50/60Hz
Power consumption:	85W
Operating temp:	-20°F to +149°F (-20°C to +65°C)
Battery:	3.6V 10Ah Nimh
Battery life:	4 years
Battery duration:	> 3 hours
Harmonics:	IEC 61000-3-2
Noise requirements/EMC:	FCC Title 47, Subpart B, Section 15, Class A device. RF Immunity; 10V/m, 80MHz-1GHz
Surge protection:	EN 61000-4-5 4 kV line to line 4 kV line to ground
THD:	< 20%
Power factor:	> 0.9

Construction:

Finish:	Superior dual coat finish - Sealed polyester topcoat - Chemical resistant epoxy primer
Lens:	Polycarbonate

Photometric Information:

CRI:	75
CCT:	5000 (cool white)
IES files:	Available upon request

All values typical unless otherwise stated
Lumen values are typical (tolerance +/- 10%)

DuroSite LED Linear - UL / CSA

Battery Backup Wiring Configurations (optional)

Side Entry

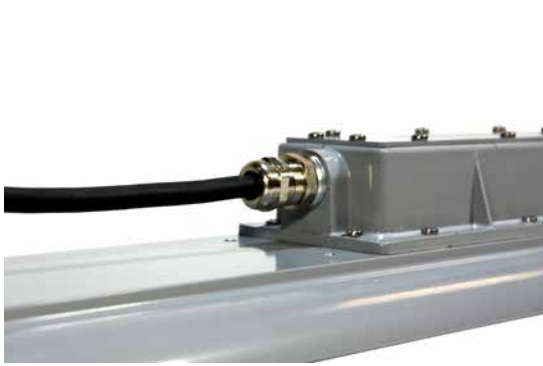

Add one of the following suffixes to the above part numbers for factory wired and installed 10' cable and cable gland:

- GS added for installed on one of the side entries (shown to the left)
- GT added for installed on the top entry (not shown)

Ex. LSM3C4MEP becomes LSM3C4MEP**GS**

Top Entry



Add one of the following suffixes to the above part numbers for factory wired and installed 10' cable and 3/4" conduit fitting.:

- CT added for installed on the top entry (shown to the left)
- CS added for installed on one the side entries (not shown)

Ex. LSM3C4MEP becomes LSM3C4MEP**CT**

DuroSite LED Linear - UL / CSA

Mounting and Accessories

Low Profile Linear



LPXW4LP

- Low profile mounting bracket
- Can be angled at 0° and 15°



LPXW4

- Mounting bracket
- Can be angled at 0°, 30°, 45°, 60° & 90°



LTXENDCAPKIT

- Chain mount and secondary retention bracket



LTXSAFEKIT

- Safety Cable Kit for secondary retention

Top Conduit Linear



LTXW4

- Mounting bracket
- Can be angled at 0°, 30°, 45°, 60° and 90°



LTXW4LP

- Low profile mounting bracket
- Can be angled at 0° and 15°



LTXENDCAPKIT

- Chain mount and secondary retention bracket



LTXSAFEKIT

- Safety cable kit for secondary retention



LTXLSXW4

- Retrofit bracket adapter used to connect LTM model fixtures to an existing LSXW4 bracket

Battery Backup Linear



LSXW4

- Mounting bracket
- Can be angled at 0°, 30°, 45°, 60° and 90°



LSXENDCAPKIT

- Chain mount brackets



LZXSAFEKIT

- Safety cable kit

DuroSite LED Linear - UL / CSA

Low Profile - Ordering Information and Light Distribution Pattern

Part Number	Length	CRI	Fixture Lumen	Watt	LPW	Warranty	Voltage	CCT	Lens	Optical Pattern
LPM3C4M2P	4'	75	7,250	66	110	5yr	100 - 277 V AC	5000K (cool white)	Clear Polycarbonate	Circular
LPM3C4H2D	4'	75	6,900	66	105	5yr	100 - 277 V AC	5000K (cool white)	Textured Polycarbonate	Circular
LPM3C4H2W	4'	75	6,700	66	102	5yr	100 - 277 V AC	5000K (cool white)	Diffused polycarbonate	Circular
LPM3B4M2P	4'	80	6,500	66	98	5yr	100 - 277 V AC	5000K (cool white)	Clear Polycarbonate	Circular
LPM3B4H2D	4'	80	6,200	66	94	5yr	100 - 277 V AC	5000K (cool white)	Textured Polycarbonate	Circular
LPM3B4H2W	4'	80	6,000	66	91	5yr	100 - 277 V AC	5000K (cool white)	Diffused polycarbonate	Circular
LPM3C4D2P	2'	75	3,600	33	109	5yr	100 - 277 V AC	5000K (cool white)	Clear Polycarbonate	Circular
LPM3C4B2D	2'	75	3,400	33	103	5yr	100 - 277 V AC	5000K (cool white)	Textured Polycarbonate	Circular
LPM3C4B2W	2'	75	3,300	33	100	5yr	100 - 277 V AC	5000K (cool white)	Diffused polycarbonate	Circular
LPM3B4D2P	2'	80	3,200	33	97	5yr	100 - 277 V AC	5000K (cool white)	Clear Polycarbonate	Circular
LPM3B4B2D	2'	80	3,000	33	91	5yr	100 - 277 V AC	5000K (cool white)	Textured Polycarbonate	Circular
LPM3B4B2W	2'	80	2,900	33	88	5yr	100 - 277 V AC	5000K (cool white)	Diffused polycarbonate	Circular

All values typical unless otherwise stated, Lumen values are typical (tolerance +/- 10%).

Light Distribution Pattern

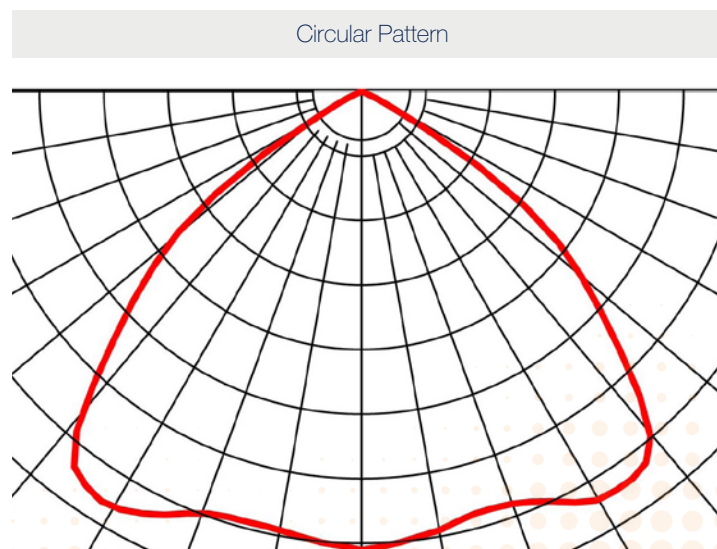

DuroSite LED Linear - UL / CSA

Top Conduit - Ordering Information and Light Distribution Pattern

Part Number	Length	CRI	Fixture Lumen	Watt	LPW	Warranty	Voltage	CCT	Lens	Optical Pattern
LTM3C4M2P	4'	75	7,250	66	110	5yr	100 - 277 V AC	5000K (cool white)	Clear Polycarbonate	Circular
LTM3C4H2D	4'	75	6,900	66	105	5yr	100 - 277 V AC	5000K (cool white)	Textured Polycarbonate	Circular
LTM3C4H2W	4'	75	6,700	66	102	5yr	100 - 277 V AC	5000K (cool white)	Diffused polycarbonate	Circular
LTM3B4M2P	4'	80	6,500	66	98	5yr	100 - 277 V AC	5000K (cool white)	Clear Polycarbonate	Circular
LTM3B4H2D	4'	80	6,200	66	94	5yr	100 - 277 V AC	5000K (cool white)	Textured Polycarbonate	Circular
LTM3B4H2W	4'	80	6,000	66	91	5yr	100 - 277 V AC	5000K (cool white)	Diffused polycarbonate	Circular
LTM3C4D2P	2'	75	3,600	33	109	5yr	100 - 277 V AC	5000K (cool white)	Clear Polycarbonate	Circular
LTM3C4B2D	2'	75	3,400	33	103	5yr	100 - 277 V AC	5000K (cool white)	Textured Polycarbonate	Circular
LTM3C4B2W	2'	75	3,300	33	100	5yr	100 - 277 V AC	5000K (cool white)	Diffused polycarbonate	Circular
LTM3B4D2P	2'	80	3,200	33	97	5yr	100 - 277 V AC	5000K (cool white)	Clear Polycarbonate	Circular
LTM3B4B2D	2'	80	3,000	33	91	5yr	100 - 277 V AC	5000K (cool white)	Textured Polycarbonate	Circular
LTM3B4B2W	2'	80	2,900	33	88	5yr	100 - 277 V AC	5000K (cool white)	Diffused polycarbonate	Circular

All values typical unless otherwise stated, Lumen values are typical (tolerance +/- 10%).

Part numbers listed in the table above are cool white. For neutral white model, replace the 5th character with **N**. Ex. LTM3C4D2P becomes LTM3N4D2P

Light Distribution Pattern

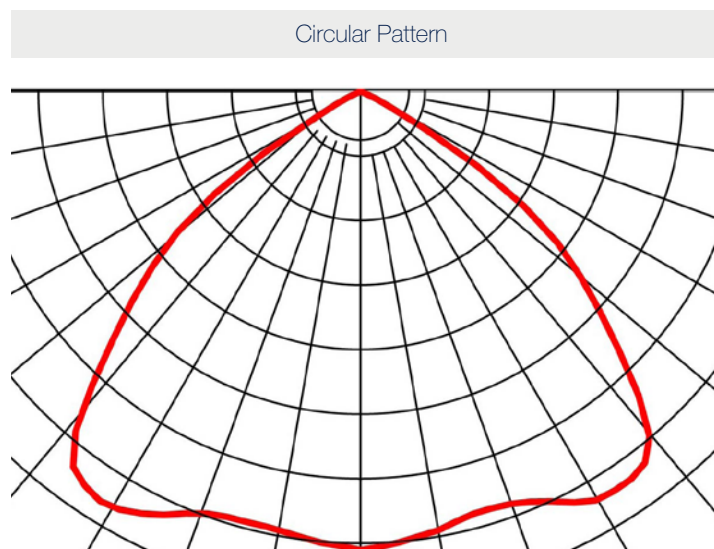

DuroSite LED Linear - UL / CSA

Battery Backup - Ordering Information and Accessories

Part Number	Length	Type	CRI	Fixture Lumen	Watt	LPW	Warranty	Voltage	CCT	Lens	Optical Pattern
LSM3C4MEP	4'	Sustained	75	7,000	85	85	5yr	120 - 277 V AC	5000K (cool white)	Polycarbonate	Circular
LSM3C4MNP	4'	Maintained	75	7,000	85	85	5yr	120 - 277 V AC	5000K (cool white)	Polycarbonate	Circular

All values typical unless otherwise stated, Lumen values are typical (tolerance +/- 10%).

Light Distribution Pattern

Circular Pattern

