

FEMALE END VIEW		SPECIFICATIONS	
		HOUSING MATERIAL/PLATING	BRASS/NICKEL
1 = BROWN 2 = WHITE 3 = BLUE 4 = BLACK		CONTACT CARRIER MATERIAL/COLOR	TPU/BLACK
		CONTACT MATERIAL/PLATING	BRASS/GOLD
		O-RING MATERIAL	NITRILE
		RATED CURRENT [A]	9.0 A
		RATED VOLTAGE [V]	600 V
		CONDUCTOR INSULATION MATERIAL	PVC
		NUMBER OF CONDUCTORS [AWG]	4x18 AWG
		TEMPERATURE RATING	-40°C to +105°C (-40°F to +221°F)
		PROTECTION CLASS	NEMA 1,3,4,6P,12 & IECIP67, IP68,IP69,IP69K

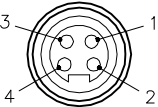
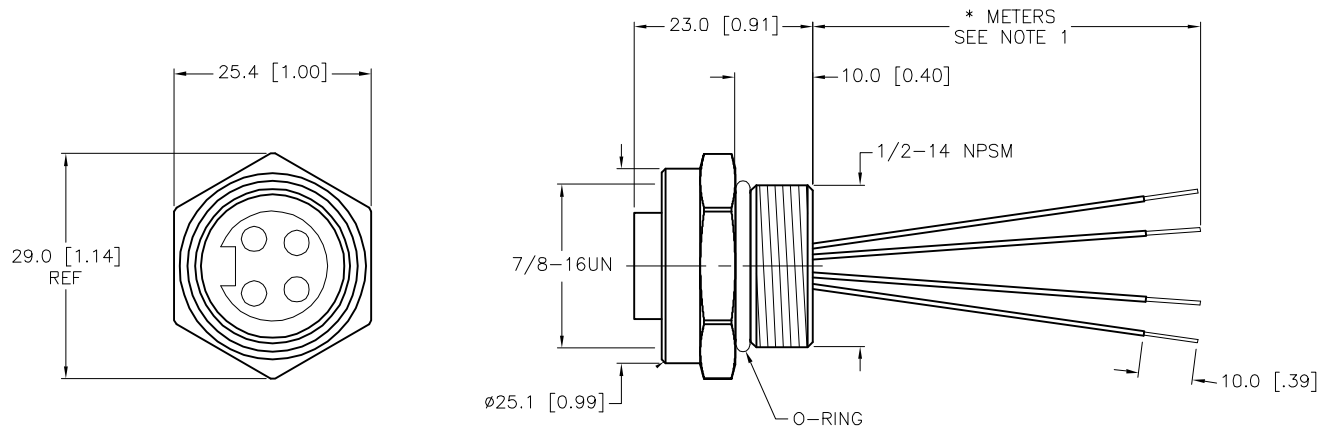

CABLE LENGTH	TOLERANCE*
ALL LENGTHS	+ 4% (OR 50mm) OF LENGTH - 0% (OR 0mm) OF LENGTH WHICHEVER IS GREATER
STRIP LENGTH	TOLERANCE*
0-7mm	±0.5mm
8-29mm	±1.0mm
30-49mm	±2.0mm
50-69mm	±3.0mm
70-100mm	±4.0mm
OVER 100mm	±5.0mm
* UNLESS OTHERWISE SPECIFIED	

NOTES:

1. "*" INDICATES LEAD LENGTH IN METERS. CONTACT TURCK TO ORDER SPECIFIC LENGTHS.

SOURCE DRAWING - FOR REFERENCE ONLY

RELATED DOCUMENTS				3RD ANGLE PROJECTION		THIS DRAWING IS CONFIDENTIAL AND THE PROPERTY OF TURCK INC. USE OF THIS DOCUMENT WITHOUT WRITTEN PERMISSION IS PROHIBITED.		3000 CAMPUS DRIVE MINNEAPOLIS, MN 55441 1-800-544-7769 (763) 553-7300 (763) 553-0708 fax www.turck.us	
1. 2. 3. 4.						DRFT JBU		DATE 12/29/00	
MATERIAL				ALL DIMENSIONS DISPLAYED ON THIS DRAWING ARE FOR REFERENCE ONLY		DSGN		SCALE 1=1.0	
FINISH				CONTACT TURCK FOR MORE INFORMATION		UNIT OF MEASUREMENT MILLIMETER [INCH]		DESCRIPTION RKF 40-*M	
SEE SPECIFICATIONS				SEE SPECIFICATIONS		DO NOT SCALE THIS DRAWING		IDENTIFICATION NO.	
D UPDATE PROTECTION CLASS				CBM 04/13/21		76628		REV D	
REV DESCRIPTION				BY DATE ECO NO.		FILE: 777000150		SHEET 1 OF 1	