

# SPECIFICATION SHEET

DELAY ON RELEASE

PAGE

1 of 1



**DIVERSIFIED ELECTRONICS**  
 1511 East Main Street  
 Leesburg, FL 34748-5336  
 Phone: (800) 874-0619

**CUSTOMER**

**ISSUED**

11-17-94

**CUSTOMER PART NO.**

**DIVERSIFIED ELECTRONICS PART NO.**

TDD-0176

**SUPPLY VOLTAGE:** 120 VAC, 50/60 Hz

**TIMING RANGE:** .1 to 10 Seconds (Adjustable With External Resistor)

**TIMING TOLERANCE**  
 Minimum Setting: +0 to -20%  
 Maximum Setting: ±10%

**REPEATABILITY:** ±1% Maximum (No First Cycle Effect)

**RESET TIMES**  
 Before Time Out: 100 Milliseconds  
 After Time Out: 50 Milliseconds  
 Recycle Time: 40 Milliseconds

**OUTPUT RATING:** DPDT, 10 Amps, Resistive @120 VAC or 24 VDC  
 211 VA @ 120 VAC, Inductive

**TEMPERATURES**  
 Operate: -0°C to +55°C  
 Storage: -45°C to +85°C

**POWER REQUIRED:** 3 Watts (Approximately)

**REVERSE POLARITY PROTECTION:** Yes

**FALSE TRANSFER:** No

**DUTY CYCLE:** Continuous

REV.	DATE	E.C.O.	APP.

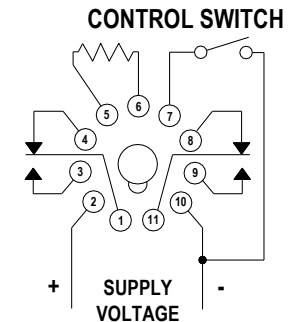
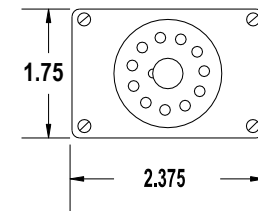
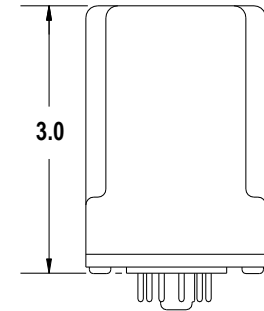

**OPERATION:** Voltage is continuously applied to the input. An external isolated switch controls the timer. When closed, the relay energizes. Opening the switch initiates the delay period. Upon completion of the delay period, the relay de-energizes. Opening the switch initiates the delay period. Upon completion of the delay period, the relay de-energizes. If the control switch re-closes during the delay period, the relay remains energizes and the timer resets to zero.